

# BioOx Reactor 85 / 300 / 650

## QUICKSTART GUIDE



Please use QR code to download full guide for **important weekly maintenance**.  
Or visit [www.bioox.us/support.html](http://www.bioox.us/support.html)

Scan this QR code with your smart phone to download full manual.

Move unit to its desired location before filling.



1

Remove fan housing and thread water pump wire through slit in core pipe. Replace fan housing.

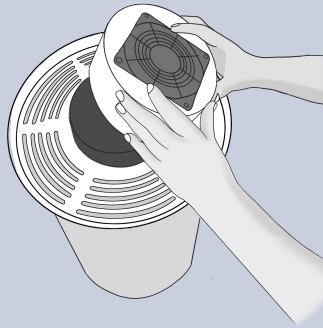

2

Position unit so the high and low markings are visible.



3

Fill unit with water through the plastic grille **midway** between the high and low markings.



4

Plug both the fan and pump cords into electrical outlet.

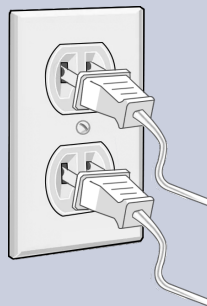

5

Check fan for airflow and pump discharge tee on distributor plate for water flow.



6

Shake BioOx Media bottle(s) vigorously. This activates the enzymes.



7

Turn this page over for dosage schedule and add the appropriate amount of BioOx Media.



8

Your BioOx Reactor setup is complete.



9

# Dosage Schedule

This is the amount of BioOx Media required for your Bio-reactor(s) / Scrubber(s).

**WARNING:** CHOOSE EITHER A WEEKLY OR MONTHLY ROUTINE. **DO NOT USE BOTH.**

## \*Minimum Weekly Dosages (Recommended)

| Model        | BioOx Media Initial Dosage | BioOx Media Weekly Dosage |
|--------------|----------------------------|---------------------------|
| Reactor 85   | 250ml                      | +60 ml / week             |
| Reactor 300  | 600 ml                     | +120 ml / week            |
| Reactor 650  | 1250 ml                    | +240 ml / week            |
| Reactor 5000 | 3000 ml                    | +480 ml / week            |

## \*Minimum Monthly Dosages

| Model        | BioOx Media Initial Dosage | BioOx Media Monthly Dosage |
|--------------|----------------------------|----------------------------|
| Reactor 85   | 250ml                      | +250 ml / month            |
| Reactor 300  | 600 ml                     | +500 ml / month            |
| Reactor 650  | 1250 ml                    | +1000 ml / month           |
| Reactor 5000 | 3000 ml                    | +2000 ml / month           |

\*This chart represents the **minimum dosage requirement** in order to filter your air effectively. Do not hesitate to add more for your specific industry or to perform a more aggressive air purification cycle.